

SCHEDULE 'A4'

ZONE MAP CORPORATION OF THE TOWNSHIP OF UXBRIDGE

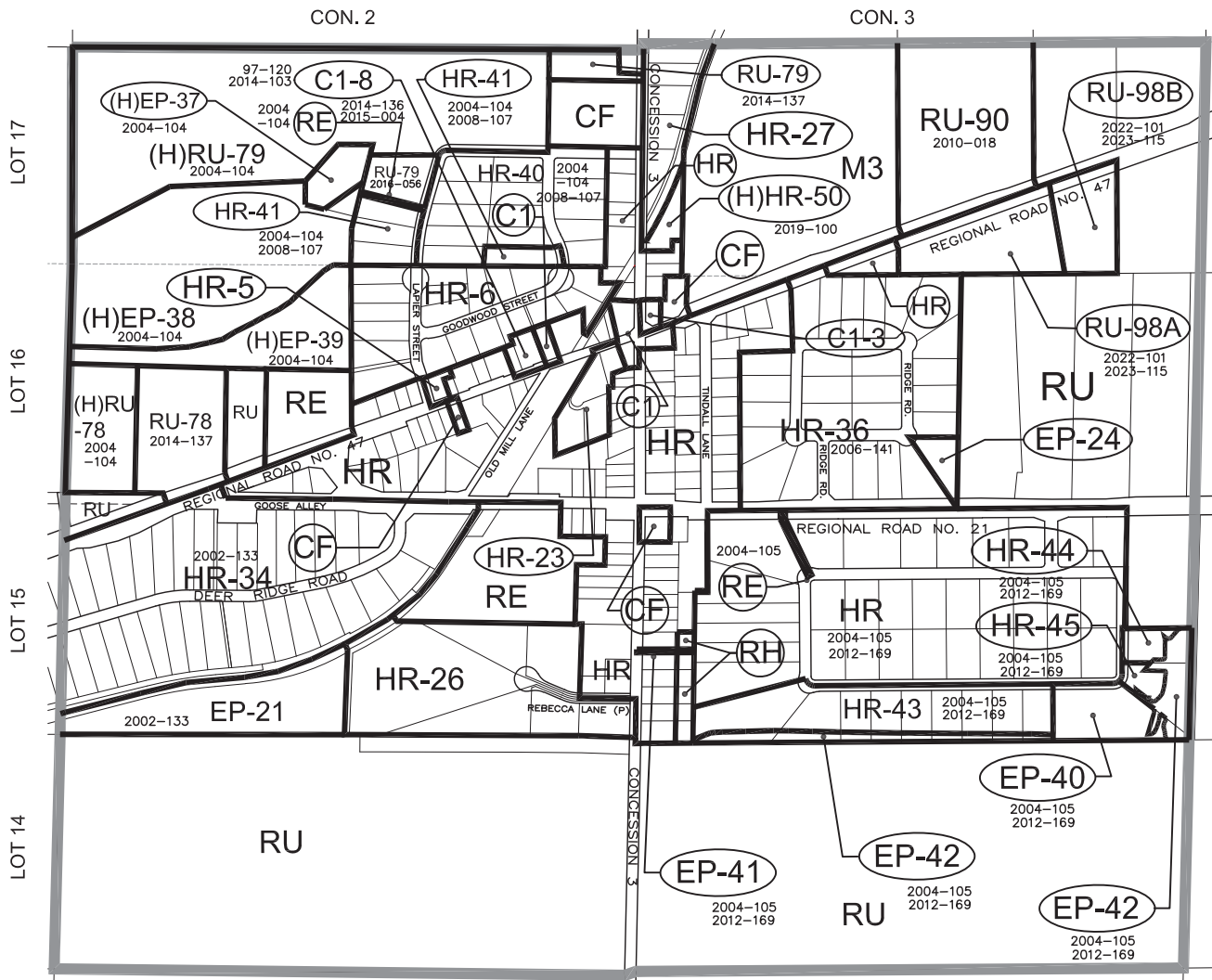

DETAIL OF GOODWOOD AREA

GENERAL ZONE CATEGORIES

- | | |
|----------------------------------|----------------------------|
| EP ENVIRONMENTAL PROTECTION ZONE | C1 HAMLET COMMERCIAL ZONE |
| RE RECREATIONAL ZONE | CF COMMUNITY FACILITY ZONE |
| RU RURAL ZONE | M1 RURAL INDUSTRIAL ZONE |
| HR HAMLET RESIDENTIAL ZONE | |

Note:

This Schedule 'A4' has been prepared for consolidation purposes only. It incorporates those amendments to Schedule 'A4' as of December 31, 2023. For accurate reference, the original of the individual by-law should be consulted.

