

PART EIGHT
BY-LAW SCHEDULES

8. BY-LAW SCHEDULES

- (a) The following Schedules "A1", "A2", "A3", "A4", "A5" and "A6", which are attached hereto and form part of this By-law, contain thereon the various Zone classifications for all lands within the Township. The Schedules apply to the following lands within the Township:
- | | | |
|------|---------------------|---|
| i. | Schedule "A1"& "A2" | Uxbridge Urban Area |
| ii. | Schedule "A3" | Corporation of the Township of Uxbridge South |
| iii. | Schedule "A4" | Unincorporated Hamlets of Coppins Corners, Goodwood and Siloam |
| iv. | Schedule "A5" | Corporation of the Township of Uxbridge North |
| vi. | Schedule "A6" | Unincorporated Hamlets of Leaskdale, Sandford, Udora and Wagner Lake and Zephyr |
- (b) The following Schedules "B1" and "B2", which are attached hereto and form part of this By-law, designate thereon the improved public Township roads which existed as of the date of final passing of this By-law. The Schedules apply to the following lands within the Township:
- | | | |
|-----|---------------|--|
| i. | Schedule "B1" | Uxbridge Urban Area Improved Public Township Roads |
| ii. | Schedule "B2" | Former Townships of Scott and Uxbridge Improved Public Township Roads |

EXPLANATORY NOTE**IMPERIAL EQUIVALENTS OF METRIC SYSTEM OF MEASURE**

The following chart is intended to advise the reader of the metric measurements appearing in this By-law and the approximate equivalent in the previous Imperial or British system of measure. This chart is for reference purposes only and to assist the reader in the interpretation of the By-law. In no instance should the Imperial System equivalent be used to determine any requirement of this By-law. Rather, all measurements are to be in the metric system and in accordance with the provisions of this By-law which serve to regulate the erection or use of any building or structure.

| <u>METRIC SYSTEM</u> | <u>APPROXIMATE EQUIVALENT IMPERIAL MEASURE</u> |
|--------------------------|--|
| <u>AREA MEASUREMENTS</u> | |
| <u>Square Metres</u> | <u>Square Feet</u> |
| 9,200 | 99,030 |
| 8,000 | 86,110 |
| 7,500 | 80,730 |
| 4,000 | 43,060 |
| 3,000 | 32,290 |
| 2,300 | 24,760 |
| 2,050 | 22,065 |
| 1,900 | 20,450 |
| 1,850 | 19,915 |
| 1,400 | 15,070 |
| 1,150 | 12,380 |
| 1,000 | 10,765 |
| 900 | 9,690 |
| 743 | 8,000 |
| 600 | 6,460 |
| 550 | 5,920 |
| 525 | 5,650 |
| 496 | 5,340 |
| 460 | 4,950 |
| 325 | 3,500 |
| 300 | 3,230 |
| 280 | 3,015 |
| 260 | 2,800 |
| 240 | 2,585 |
| 185 | 1,990 |
| 160 | 1,720 |
| 110 | 1,184 |
| 93 | 1,000 |
| 84 | 904 |
| 70 | 753 |
| 65 | 700 |
| 55 | 592 |
| 43 | 463 |
| 40 | 430 |
| 38 | 409 |
| 35 | 376 |
| 31 | 334 |
| 30 | 323 |
| 24 | 258 |
| 20 | 215 |
| 9 | 97 |

EXPLANATORY NOTE

IMPERIAL EQUIVALENTS OF METRIC SYSTEM OF MEASURE

| <u>METRIC SYSTEM</u> | <u>APPROXIMATE EQUIVALENT IMPERIAL MEASURE</u> |
|----------------------------|--|
| <u>AREA MEASUREMENTS</u> | |
| <u>HECTARES</u> | <u>ACRES</u> |
| 40 | 100 |
| 38.5 | 95 |
| 10 | 25 |
| 1.9 | 5 |
| <u>LINEAR MEASUREMENTS</u> | |
| <u>Metres</u> | <u>Feet</u> |
| 550 | 1,805 |
| 300 | 985 |
| 215 | 705 |
| 200 | 655 |
| 105 | 344 |
| 100 | 328 |
| 90 | 295 |
| 75 | 246 |
| 68 | 223 |
| 63 | 207 |
| 60 | 197 |
| 55 | 180 |
| 50 | 164 |
| 48 | 157 |
| 46 | 151 |
| 45 | 148 |
| 43 | 141 |
| 41 | 135 |
| 40 | 131 |
| 38 | 125 |
| 36.5 | 120 |
| 36 | 118 |
| 35 | 115 |
| 33 | 108 |
| 30.5 | 100 |
| 30 | 98 |
| 28 | 92 |
| 26 | 85 |
| 25 | 82 |
| 24 | 79 |
| 23 | 75 |
| 22.5 | 74 |
| 22 | 72 |
| 21.5 | 70 |
| 21 | 69 |
| 20 | 66 |
| 18 | 59 |
| 17 | 56 |
| 16 | 52 |
| 15.8 | 51.8 |

EXPLANATORY NOTE

IMPERIAL EQUIVALENTS OF METRIC SYSTEM OF MEASURE

| | |
|----|----|
| 15 | 49 |
| 13 | 43 |

METRIC SYSTEMAPPROXIMATE EQUIVALENT
IMPERIAL MEASURELINEAR MEASUREMENTSMetresFeet

| | |
|------|-----|
| 12 | 39 |
| 11.5 | 38 |
| 10.5 | 34 |
| 10 | 33 |
| 9 | 29 |
| 8.5 | 28 |
| 8 | 26 |
| 6 | 20 |
| 5.8 | 19 |
| 5.5 | 18 |
| 5 | 16 |
| 4 | 13 |
| 3.5 | 11 |
| 3 | 10 |
| 2.1 | 7 |
| 2 | 6.5 |
| 1.8 | 6 |
| 1.5 | 5 |
| 1.2 | 4 |
| 0.6 | 2 |
| 0.45 | 1.5 |

METRIC SYSTEMAPPROXIMATE EQUIVALENT
IMPERIAL MEASUREKilometresMiles

| | |
|-----|---|
| 3.2 | 2 |
|-----|---|

SCHEDULE 'A3' ZONE MAP CORPORATION OF THE TOWNSHIP OF UXBRIDGE

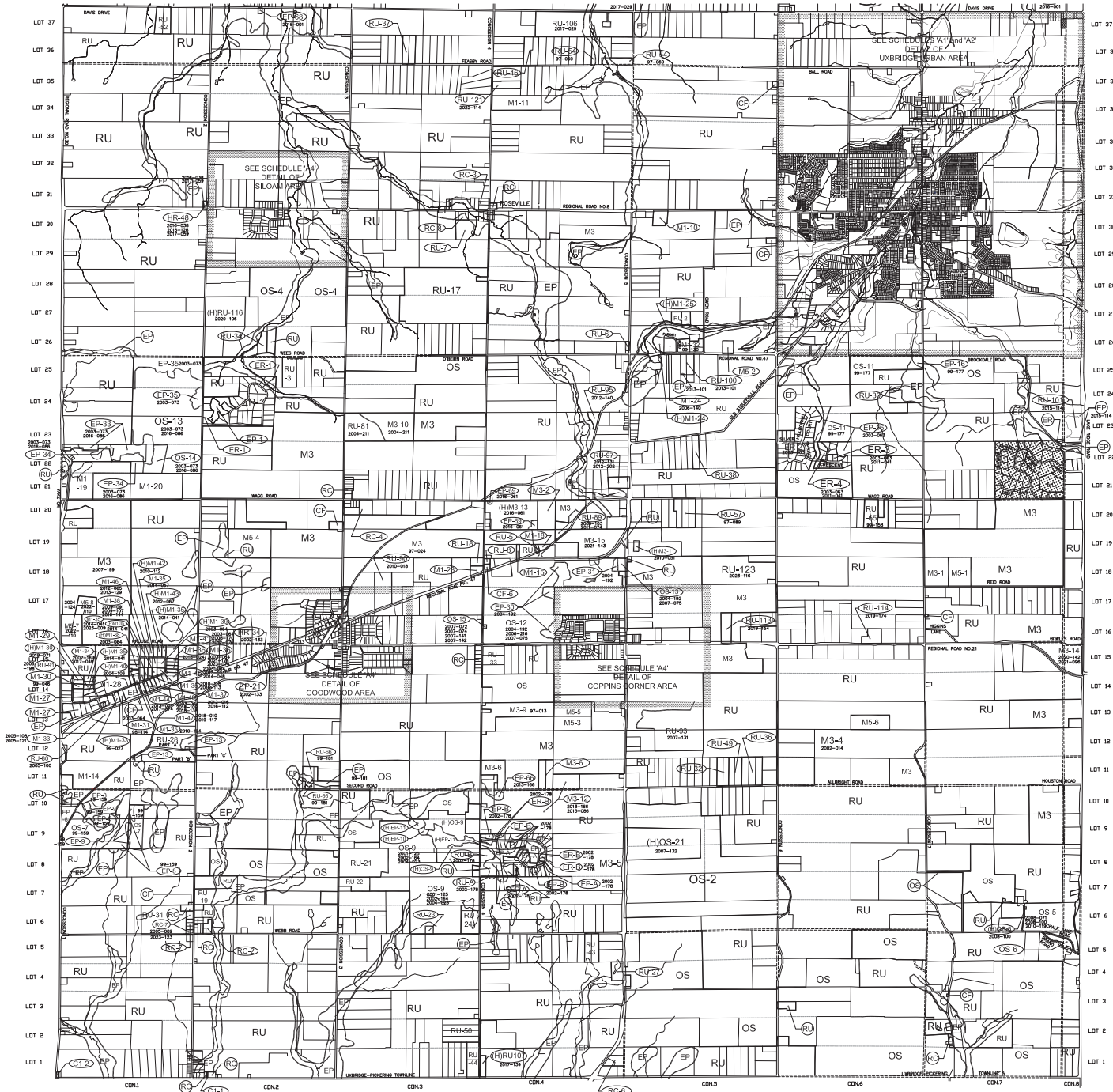

GENERAL ZONE CATEGORIES

| | |
|----------------------------------|-----------------------------------|
| EP ENVIRONMENTAL PROTECTION ZONE | RC RECREATIONAL CLUSTER ZONE |
| OS RECREATIONAL OPEN SPACE ZONE | ER ESTATE RESIDENTIAL ZONE |
| RU RURAL ZONE | M1 RURAL INDUSTRIAL ZONE |
| CF COMMUNITY FACILITY ZONE | M3 RURAL RESOURCE EXTRACTION ZONE |
| | M5 AGGREGATE PROCESSING ZONE |

Lands Affected By Freestanding By-law No. 90-39

Note:
This Schedule 'A3' has been prepared for consolidation purposes only. It incorporates those amendments to Schedule 'A3' as of December 31, 2023. For accurate reference, the original of the individual by-law should be consulted.

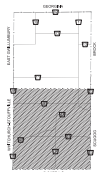

TOWNSHIP OF UXBRIDGE



SCHEDULE 'A4'

ZONE MAP CORPORATION OF THE TOWNSHIP OF UXBRIDGE

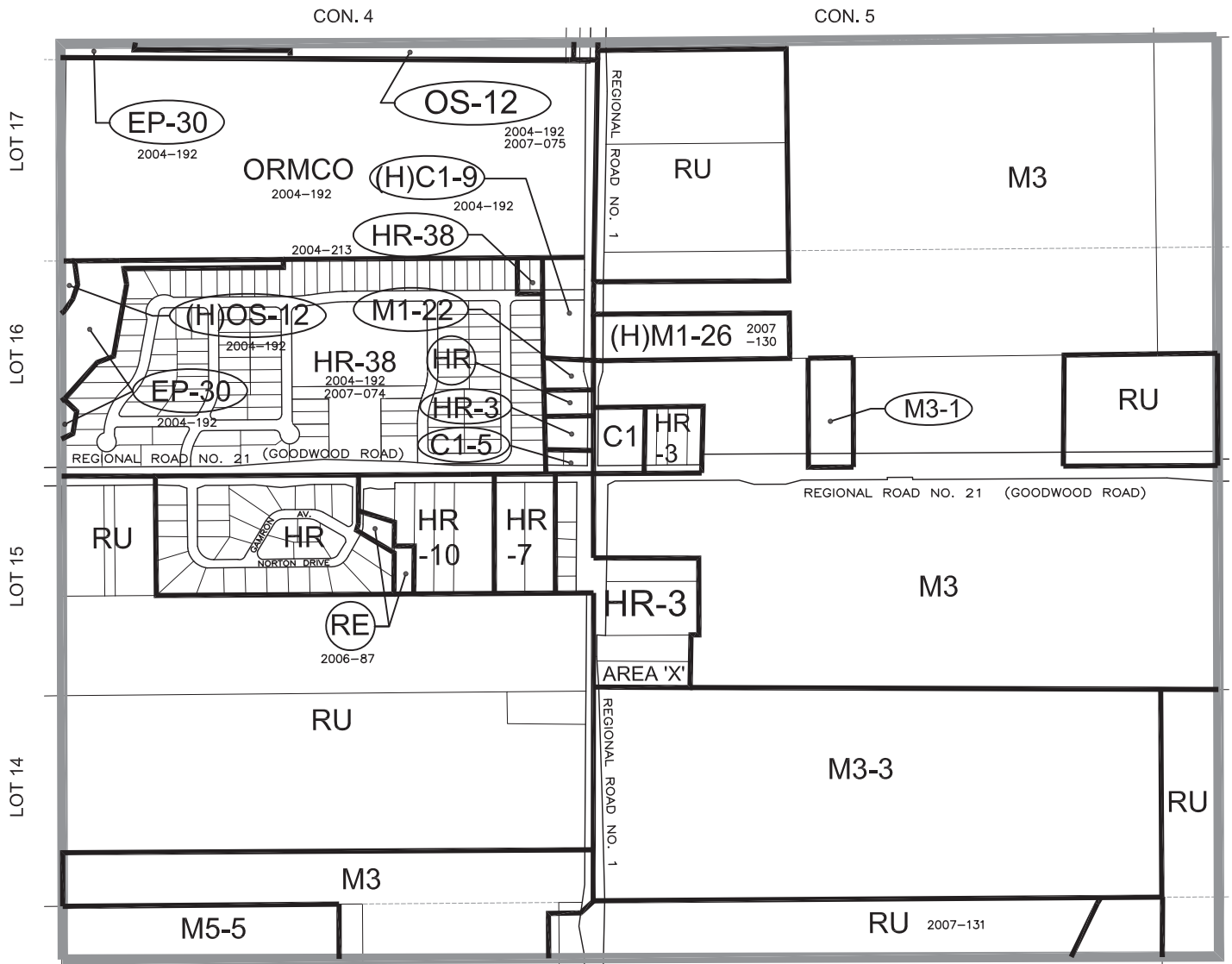

DETAIL OF COPPINS CORNERS AREA

GENERAL ZONE CATEGORIES

| | |
|----------------------------------|-----------------------------------|
| EP ENVIRONMENTAL PROTECTION ZONE | C1 HAMLET COMMERCIAL ZONE |
| RE RECREATIONAL ZONE | CF COMMUNITY FACILITY ZONE |
| RU RURAL ZONE | M1 RURAL INDUSTRIAL ZONE |
| HR HAMLET RESIDENTIAL ZONE | M3 RURAL RESOURCE EXTRACTION ZONE |

Note:

This Schedule 'A4' has been prepared for consolidation purposes only. It incorporates those amendments to Schedule 'A4' as of December 31, 2023. For accurate reference, the original of the individual by-law should be consulted.

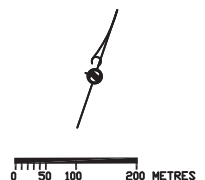

SCHEDULE 'A4'

ZONE MAP CORPORATION OF THE TOWNSHIP OF UXBRIDGE

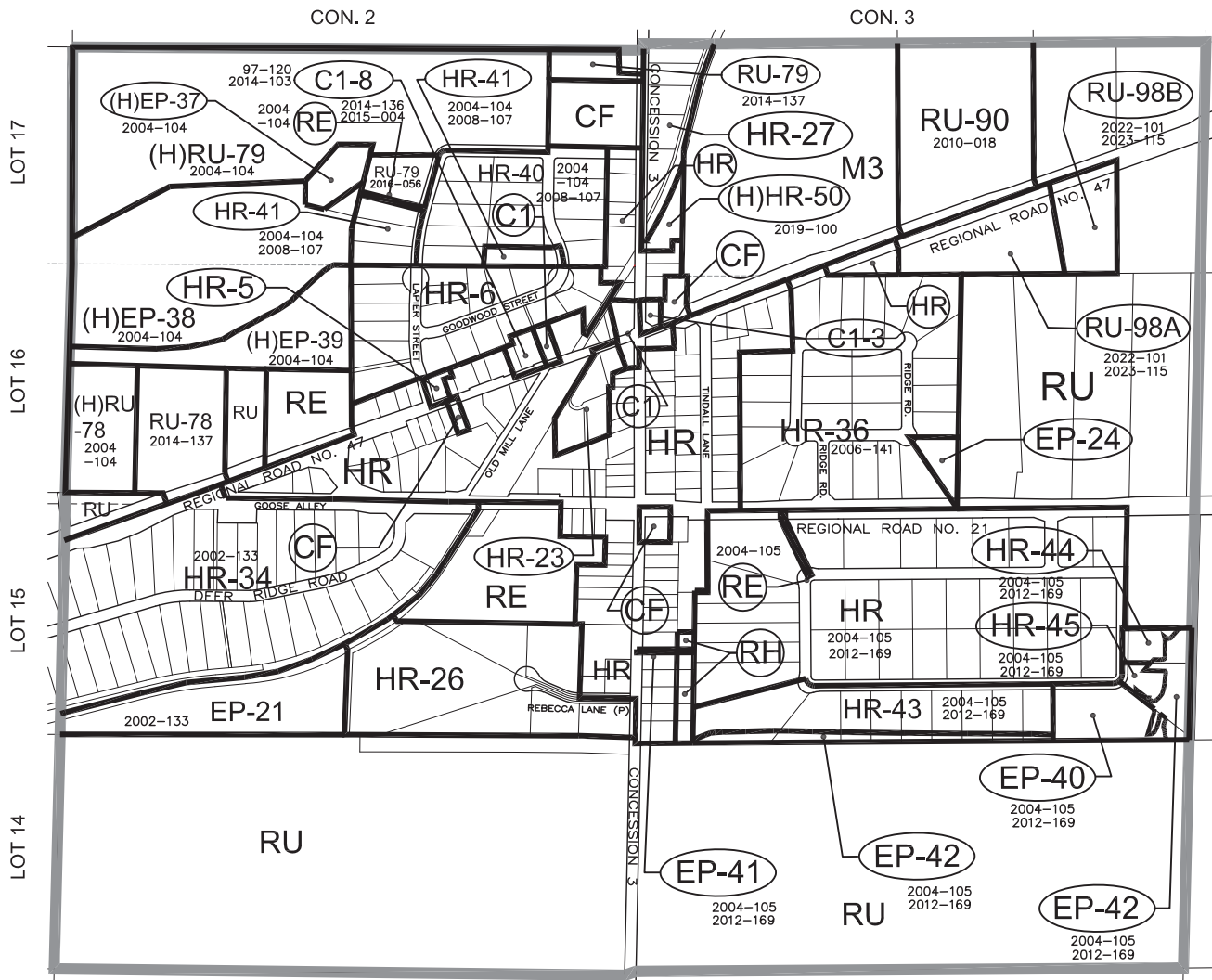

DETAIL OF GOODWOOD AREA

GENERAL ZONE CATEGORIES

- | | |
|----------------------------------|----------------------------|
| EP ENVIRONMENTAL PROTECTION ZONE | C1 HAMLET COMMERCIAL ZONE |
| RE RECREATIONAL ZONE | CF COMMUNITY FACILITY ZONE |
| RU RURAL ZONE | M1 RURAL INDUSTRIAL ZONE |
| HR HAMLET RESIDENTIAL ZONE | |

Note:

This Schedule 'A4' has been prepared for consolidation purposes only. It incorporates those amendments to Schedule 'A4' as of December 31, 2023. For accurate reference, the original of the individual by-law should be consulted.

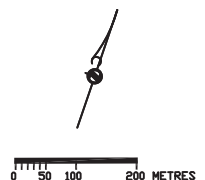

SCHEDULE 'A4'

ZONE MAP CORPORATION OF THE TOWNSHIP OF UXBRIDGE

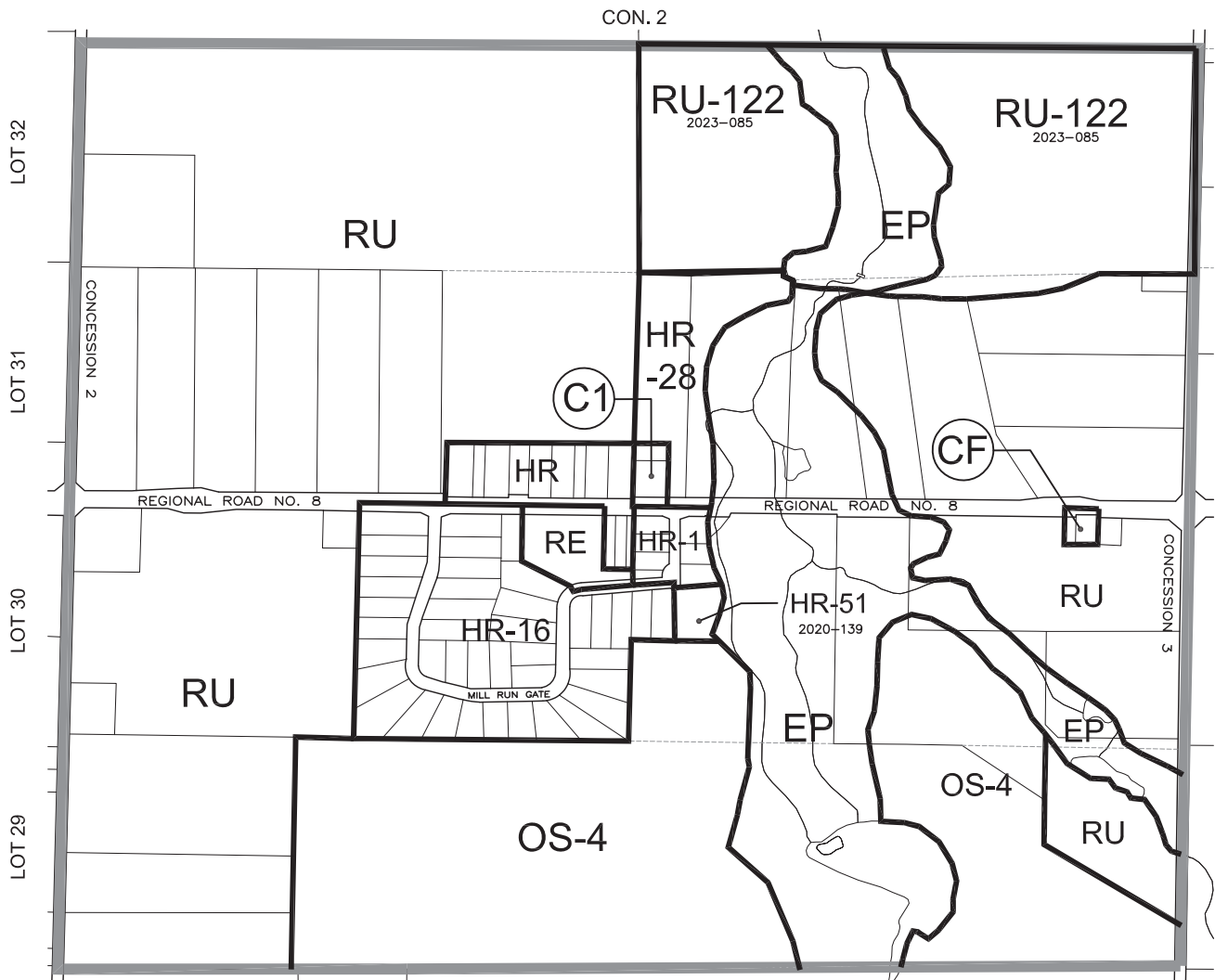

DETAIL OF SILOAM AREA

GENERAL ZONE CATEGORIES

- | | |
|----------------------------------|----------------------------|
| EP ENVIRONMENTAL PROTECTION ZONE | C1 HAMLET COMMERCIAL ZONE |
| RE RECREATIONAL ZONE | CF COMMUNITY FACILITY ZONE |
| RU RURAL ZONE | M1 RURAL INDUSTRIAL ZONE |
| HR HAMLET RESIDENTIAL ZONE | |

Note:

This Schedule 'A4' has been prepared for consolidation purposes only. It incorporates those amendments to Schedule 'A4' as of December 31, 2023. For accurate reference, the original of the individual by-law should be consulted.

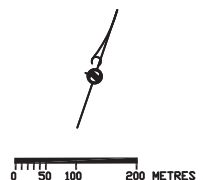

SCHEDULE 'A5' ZONE MAP CORPORATION OF THE TOWNSHIP OF UXBRIDGE

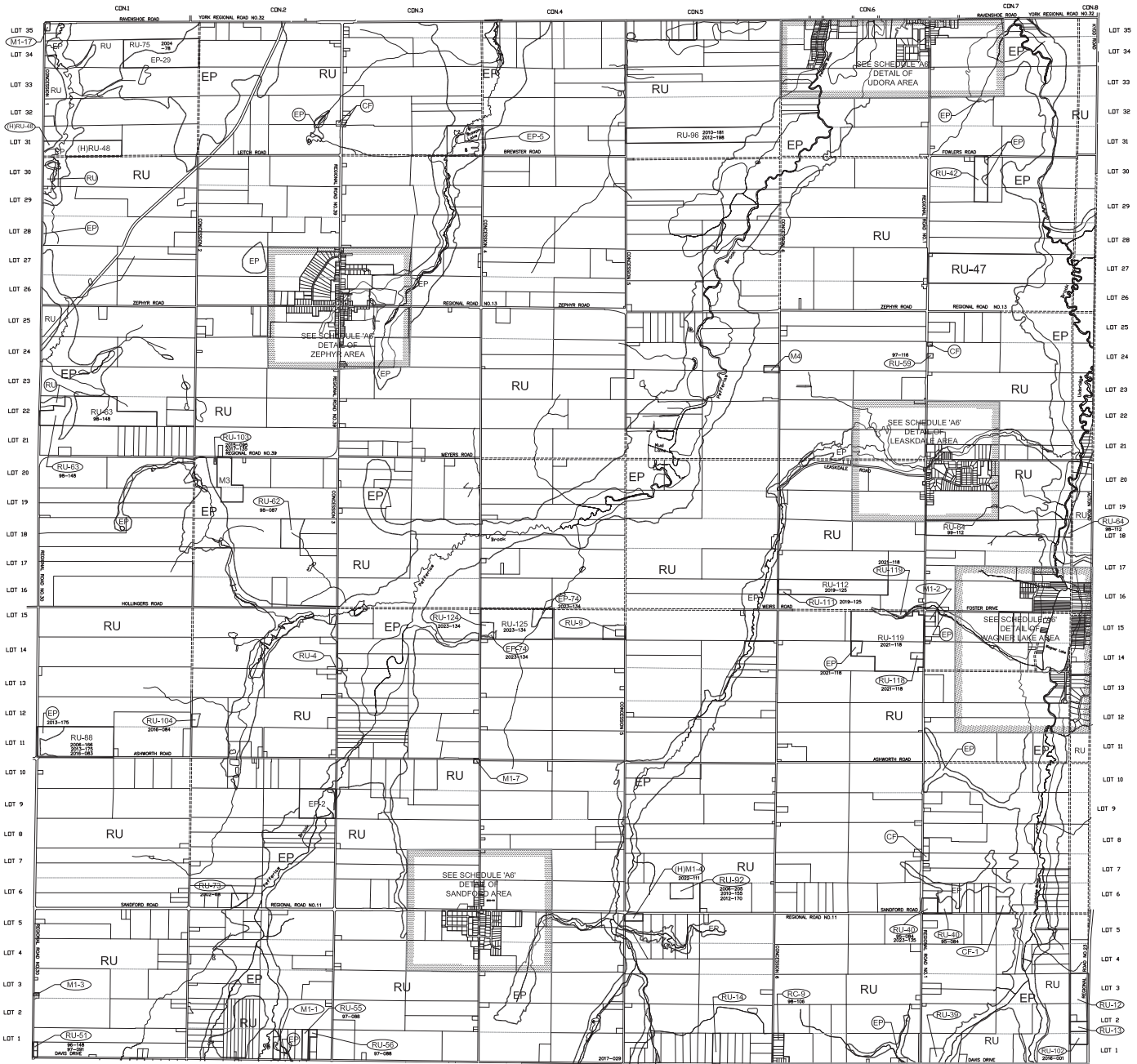

GENERAL ZONE CATEGORIES

- | | |
|----------------------------------|-----------------------------------|
| EP ENVIRONMENTAL PROTECTION ZONE | RC RECREATIONAL CLUSTER ZONE |
| OS RECREATIONAL OPEN SPACE ZONE | ER ESTATE RESIDENTIAL ZONE |
| RU RURAL ZONE | M1 RURAL INDUSTRIAL ZONE |
| CF COMMUNITY FACILITY ZONE | M3 RURAL RESOURCE EXTRACTION ZONE |
| SR SHORELINE RESIDENTIAL | M5 AGGREGATE PROCESSING ZONE |

Notes:
This Schedule 'A5' has been prepared for consolidation purposes only. It incorporates those amendments to Schedule 'A5' as of December 31, 2023. For accurate reference, the original of the individual by-law should be consulted.

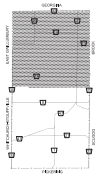

TOWNSHIP OF UXBRIDGE



SCHEDULE 'A6'

ZONE MAP CORPORATION OF THE TOWNSHIP OF UXBRIDGE

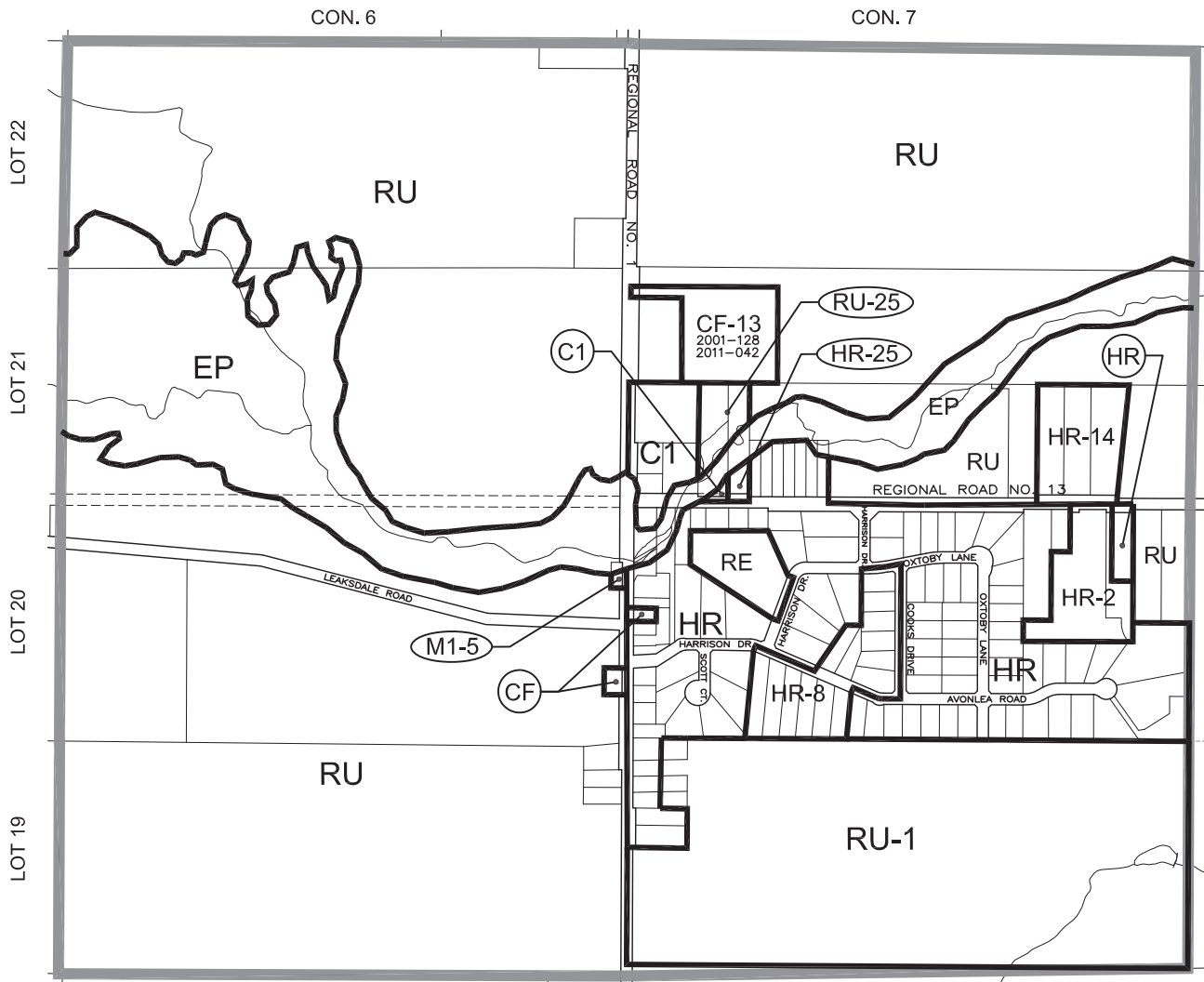

DETAIL OF LEASKDALE AREA

GENERAL ZONE CATEGORIES

- | | |
|----------------------------------|----------------------------|
| EP ENVIRONMENTAL PROTECTION ZONE | C1 HAMLET COMMERCIAL ZONE |
| RE RECREATIONAL ZONE | CF COMMUNITY FACILITY ZONE |
| RU RURAL ZONE | M1 RURAL INDUSTRIAL ZONE |
| HR HAMLET RESIDENTIAL ZONE | |

Note:

This Schedule 'A6' has been prepared for consolidation purposes only. It incorporates those amendments to Schedule 'A6' as of December 31, 2023. For accurate reference, the original of the individual by-law should be consulted.

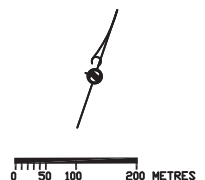

SCHEDULE 'A6'

ZONE MAP CORPORATION OF THE TOWNSHIP OF UXBRIDGE

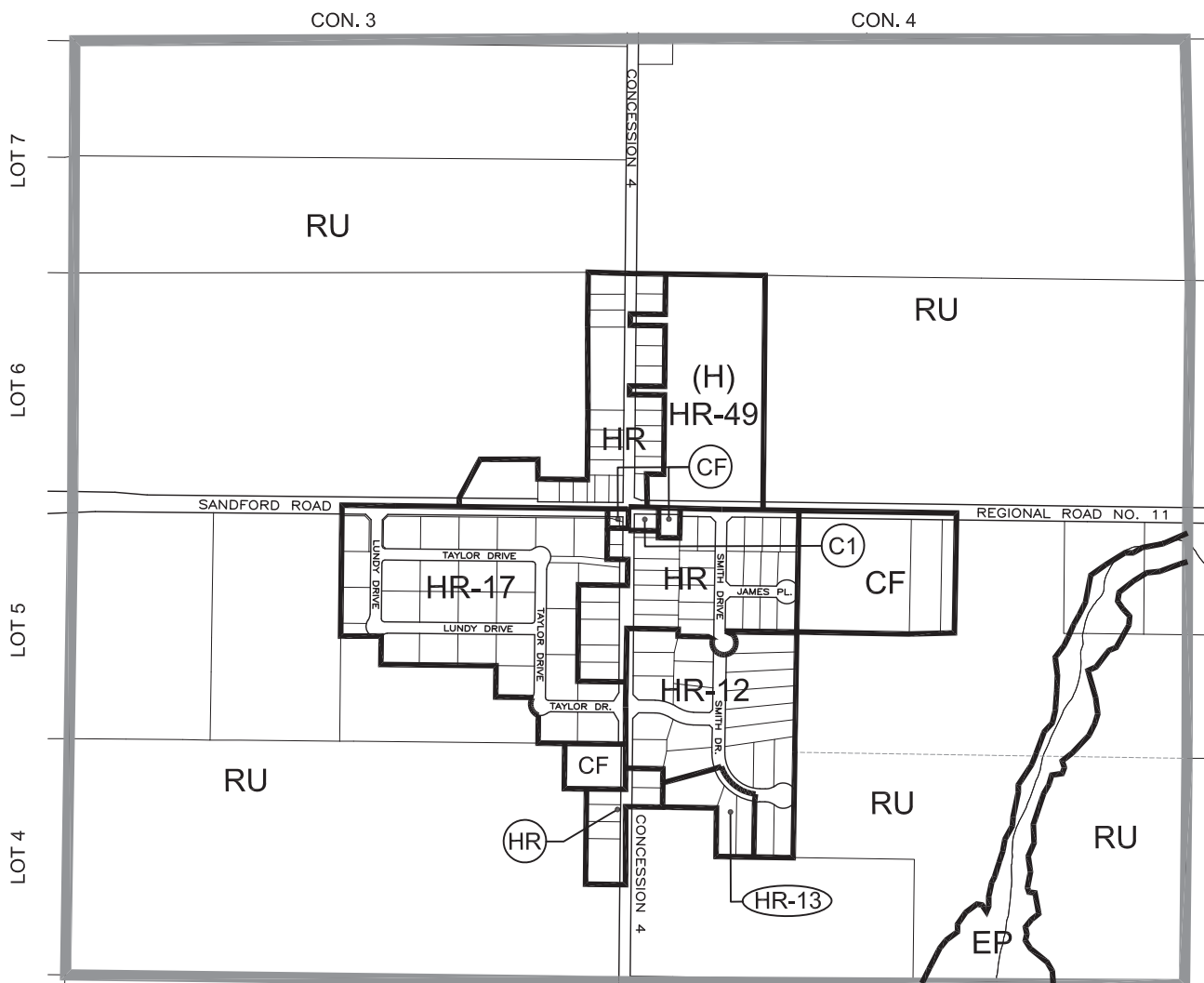

DETAIL OF SANDFORD AREA

GENERAL ZONE CATEGORIES

- | | |
|----------------------------------|----------------------------|
| EP ENVIRONMENTAL PROTECTION ZONE | C1 HAMLET COMMERCIAL ZONE |
| RE RECREATIONAL ZONE | CF COMMUNITY FACILITY ZONE |
| RU RURAL ZONE | M1 RURAL INDUSTRIAL ZONE |
| HR HAMLET RESIDENTIAL ZONE | |

Note:

This Schedule 'A6' has been prepared for consolidation purposes only. It incorporates those amendments to Schedule 'A6' as of December 31, 2023. For accurate reference, the original of the individual by-law should be consulted.

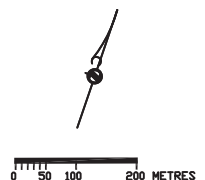

SCHEDULE 'A6'

ZONE MAP CORPORATION OF THE TOWNSHIP OF UXBRIDGE

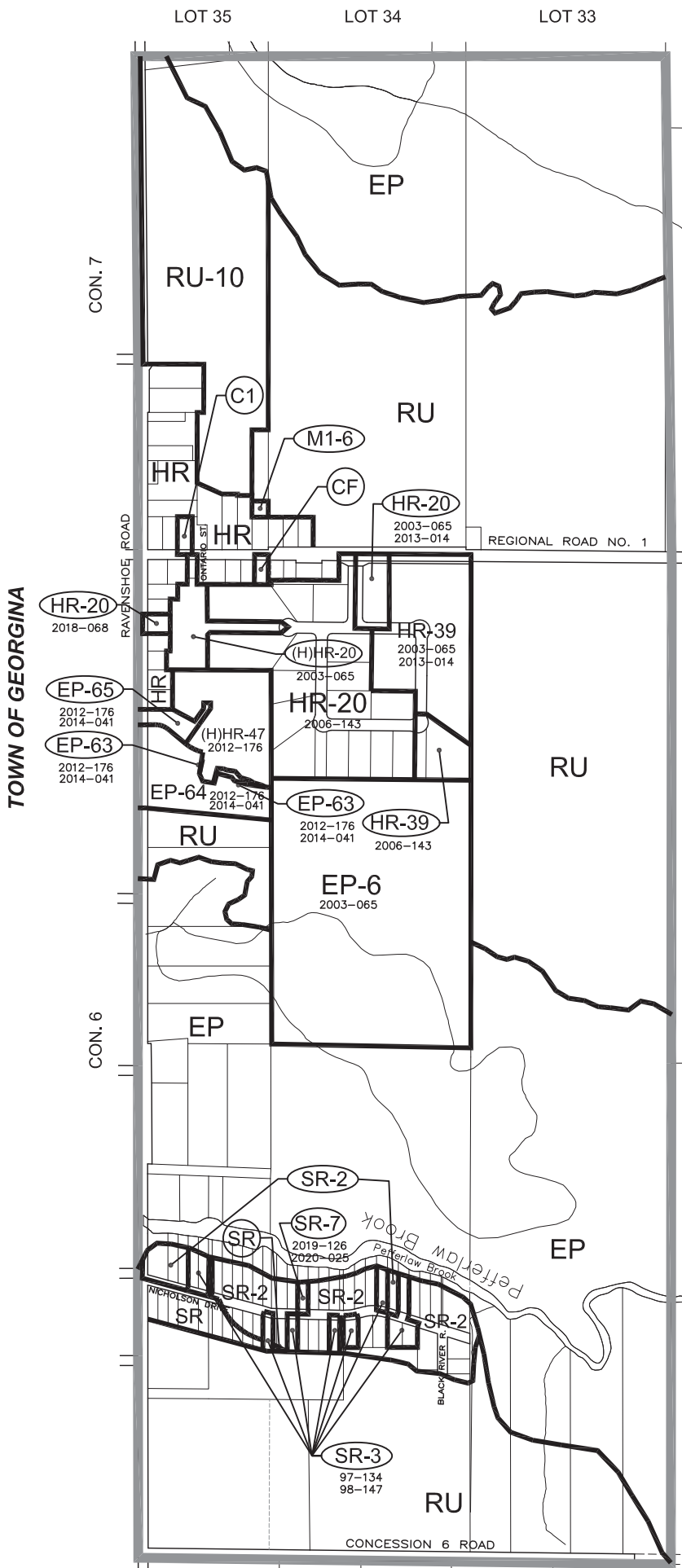

DETAIL OF UDORA AREA

GENERAL ZONE CATEGORIES

- EP ENVIRONMENTAL PROTECTION ZONE
- RU RURAL ZONE
- SR SHORELINE RESIDENTIAL ZONE
- HR HAMLET RESIDENTIAL ZONE
- RH RESIDENTIAL HOLDING ZONE
- C1 HAMLET COMMERCIAL ZONE
- CF COMMUNITY FACILITY ZONE
- M1 RURAL INDUSTRIAL ZONE

Note:

This Schedule 'A6' has been prepared for consolidation purposes only. It incorporates those amendments to Schedule 'A6' as of December 31, 2023. For accurate reference, the original of the individual by-law should be consulted.

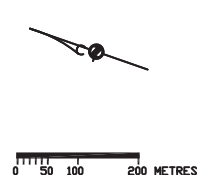

SCHEDULE 'A6'

ZONE MAP CORPORATION OF THE TOWNSHIP OF UXBRIDGE

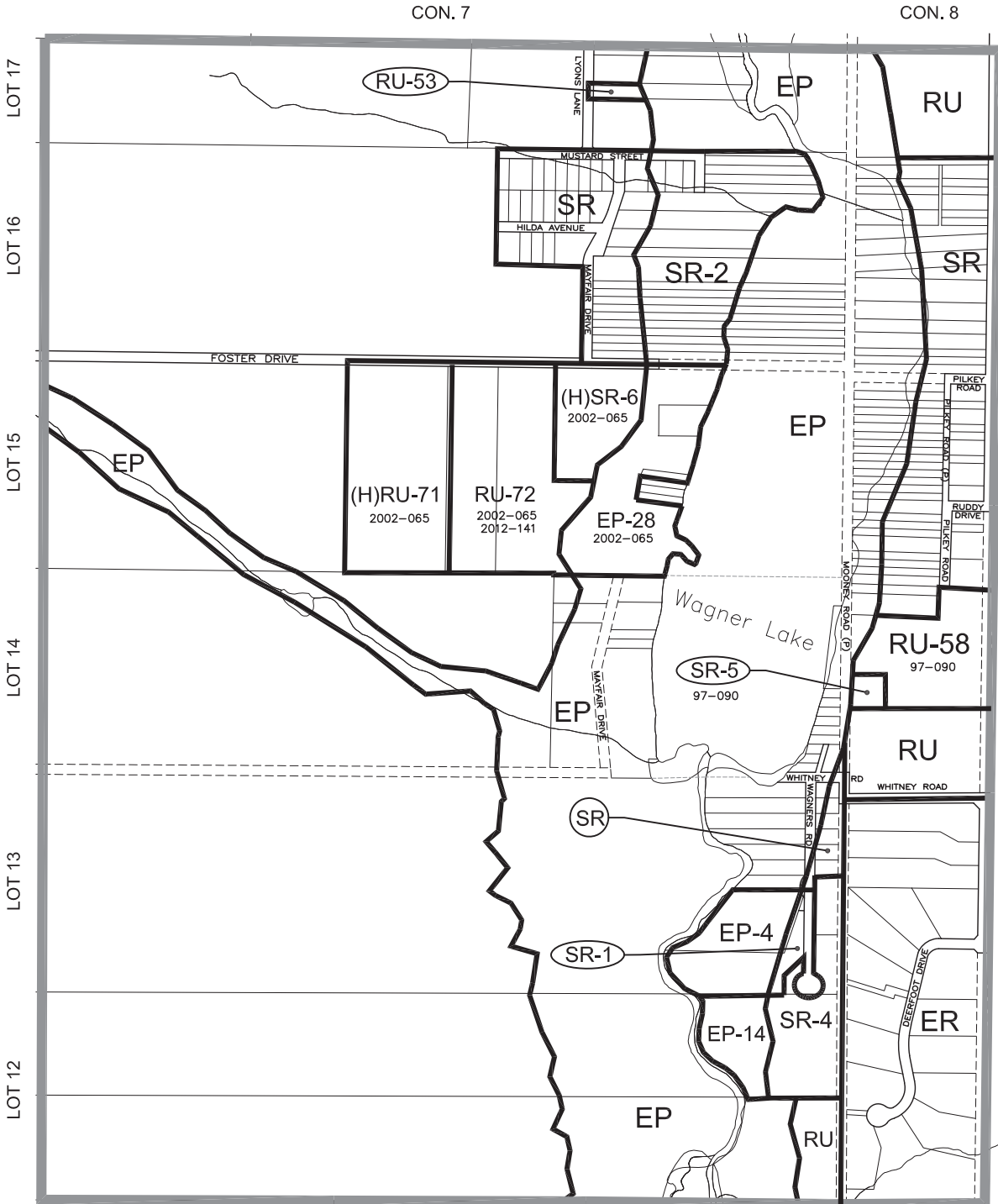

DETAIL OF WAGNER LAKE AREA

GENERAL ZONE CATEGORIES

| | |
|----------------------------------|----------------------------|
| EP ENVIRONMENTAL PROTECTION ZONE | SR SHORELINE RESIDENTIAL |
| RE RECREATIONAL ZONE | C1 HAMLET COMMERCIAL ZONE |
| RU RURAL ZONE | CF COMMUNITY FACILITY ZONE |
| HR HAMLET RESIDENTIAL ZONE | M1 RURAL INDUSTRIAL ZONE |

Note:

This Schedule 'A6' has been prepared for consolidation purposes only. It incorporates those amendments to Schedule 'A6' as of December 31, 2023. For accurate reference, the original of the individual by-law should be consulted.

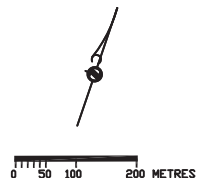

SCHEDULE 'A6'

ZONE MAP CORPORATION OF THE TOWNSHIP OF UXBRIDGE

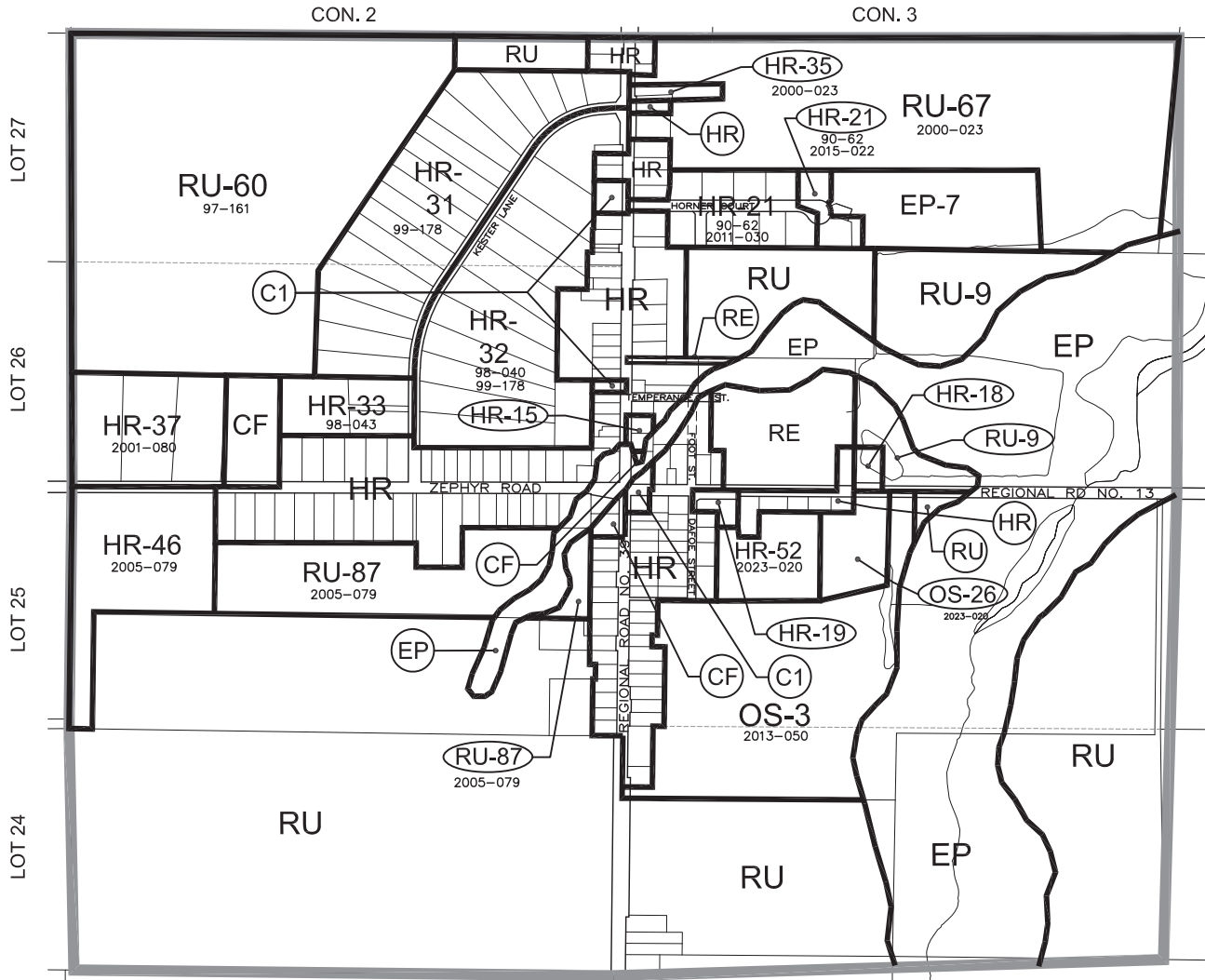

DETAIL OF ZEPHYR AREA

GENERAL ZONE CATEGORIES

- | | |
|----------------------------------|----------------------------|
| EP ENVIRONMENTAL PROTECTION ZONE | C1 HAMLET COMMERCIAL ZONE |
| RE RECREATIONAL ZONE | CF COMMUNITY FACILITY ZONE |
| RU RURAL ZONE | M1 RURAL INDUSTRIAL ZONE |
| HR HAMLET RESIDENTIAL ZONE | |

Note:

This Schedule 'A6' has been prepared for consolidation purposes only. It incorporates those amendments to Schedule 'A6' as of December 31, 2023. For accurate reference, the original of the individual by-law should be consulted.

