

ONTARIO BUILDING CODE DATA

PROJECT:
CONDOMINIUM RESIDENCE DEVELOPMENT
LOCATION:
BROCK STREET E. AND HERREMA BLVD.
UXBRIDGE, ONTARIO

- | | |
|--|-----------------------------|
| 1 PROJECT DESCRIPTION:
NEW RESIDENTIAL CONDOMINIUM BUILDING
BUILDING HEIGHT = 14.65 M (4 STOREYS) | DIV. B PART 3 |
| 2 MAJOR OCCUPANCY:
RESIDENTIAL OCCUPANCY - GROUP C | B 3.1.2.1(1) |
| 3 BUILDING AREA:
EXISTING (0.0) + NEW (1,642.20) = TOTAL 1,642.20 SQ.M. | A 1.4.1.2 |
| 4 GROSS AREA:
EXISTING (0.0) + NEW (5,933.76) = TOTAL 5,933.76 SQ.M. | A 1.4.1.2 |
| 5 NUMBER OF STOREYS:
ABOVE GRADE = 4 STOREYS, BELOW GRADE = 1 STOREY | B 3.2.1.1 & A 1.4.1.2 |
| 6 NUMBER OF STREETS / FIRE FIGHTER ACCESS:
FACING 1 STREET | B 3.2.2.10 & B 3.2.5 |
| 7 BUILDING CLASSIFICATION:
3.2.2.45, GROUP C, UP TO 4 STOREYS, SPRINKLERED | B 3.2.2.20 - B 3.2.2.83 |
| 8 SPRINKLER SYSTEM PROPOSED:
FULLY SPRINKLERED | B 3.2.2.43 & B 3.2.1.5 |
| 9 STANDPIPE REQUIRED:
YES | B 3.2.9 |
| 10 FIRE ALARM REQUIRED:
YES | B 3.2.4 |
| 11 WATER SERVICE / SUPPLY IS ADEQUATE:
YES | B 3.2.5.7 |
| 12 HIGH BUILDING:
NO | B 3.2.6 |
| 13 PERMITTED CONSTRUCTION:
COMBUSTIBLE AND NON-COMBUSTIBLE
ACTUAL CONSTRUCTION:
NON-COMBUSTIBLE | B 3.2.2.20 - B 3.2.2.83 |
| 14 MEZZANINE AREA(S):
TOTAL = 0 SQ.M. | B 3.2.1.1(3) - B 3.2.1.1(8) |
| 15 OCCUPANT LOAD:
BASEMENT (B3): 2,186.18 M2 / 46 = 48 PERSONS
GROUND FLOOR (A2): 0 PERSONS (RESIDENTS ONLY)
GROUND FLOOR (C): 28 PERSONS
SECOND FLOOR (C): 58 PERSONS
THIRD FLOOR (C): 58 PERSONS
FOURTH FLOOR (C): 58 PERSONS
TOTAL = 250 PERSONS | B 3.1.16 |
| 16 BARRIER FREE DESIGN:
YES | B 3.8 |
| 17 HAZARDOUS SUBSTANCES:
NO | B 3.3.1.2 & B 3.3.1.19 |
| 18 REQUIRED FIRE-RESISTANCE RATINGS:
GROUND FLOOR ASSEMBLY FRR = 1.5 HR. (3.3.5.6)
FLOOR ASSEMBLIES FRR = 1.0 HR.
ROOF ASSEMBLIES FRR = 0 HR.
MEZZANINE ASSEMBLIES FRR = 1.0 HR.
GROUND FLOOR SUPPORTING MEMBERS FRR = 1.5 HR.
FLOOR SUPPORTING MEMBERS FRR = 1.0 HR.
ROOF SUPPORTING MEMBERS FRR = 0 HR.
MEZZANINE SUPPORTING MEMBERS FRR = 1.0 HR. | B 3.2.2.43 & B 3.2.1.4 |

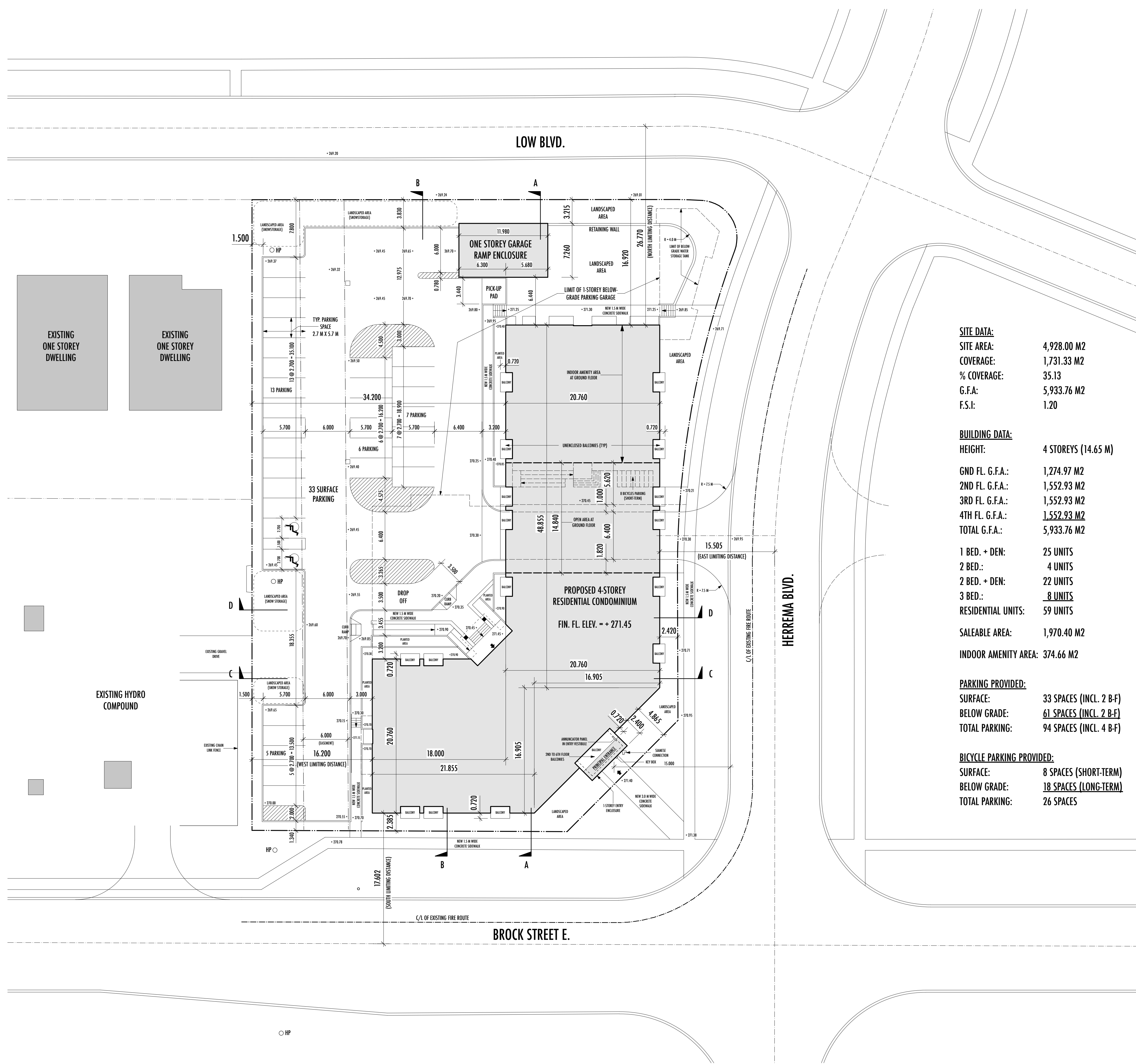

SITE DATA:
SITE AREA: 4,928.00 M2
COVERAGE: 1,731.33 M2
% COVERAGE: 35.13
G.F.A.: 5,933.76 M2
F.S.I.: 1.20

BUILDING DATA:
HEIGHT: 4 STOREYS (14.65 M)
GND FL. G.F.A.: 1,274.97 M2
2ND FL. G.F.A.: 1,552.93 M2
3RD FL. G.F.A.: 1,552.93 M2
4TH FL. G.F.A.: 1,552.93 M2
TOTAL G.F.A.: 5,933.76 M2

SALEABLE AREA: 1,970.40 M2
INDOOR AMENITY AREA: 374.66 M2

PARKING PROVIDED:
SURFACE: 33 SPACES (INCL. 2 B-F)
BELOW GRADE: 61 SPACES (INCL. 2 B-F)
TOTAL PARKING: 94 SPACES (INCL. 4 B-F)

BICYCLE PARKING PROVIDED:
SURFACE: 8 SPACES (SHORT-TERM)
BELOW GRADE: 18 SPACES (LONG-TERM)
TOTAL PARKING: 26 SPACES

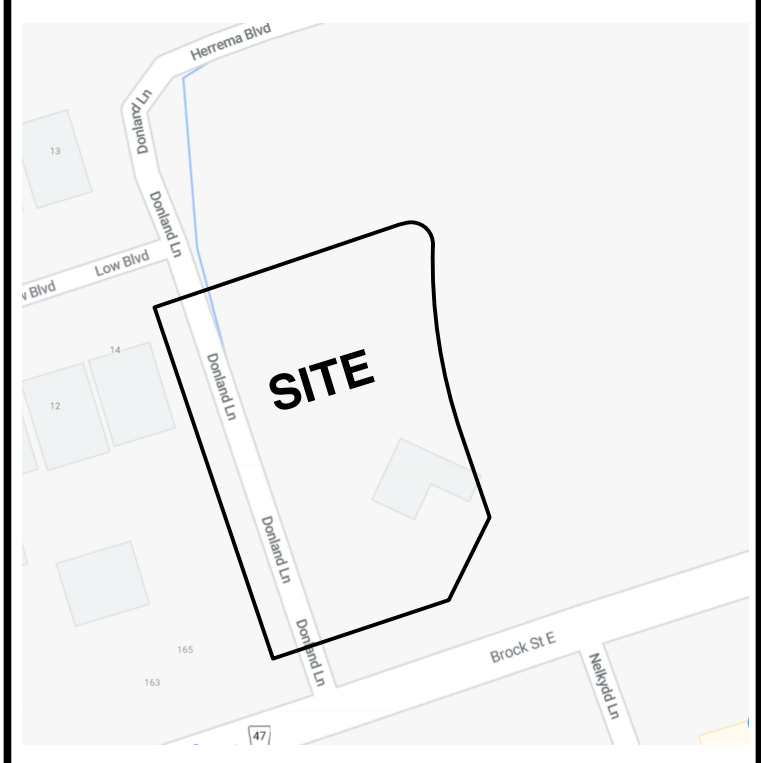

Key Plan

Issue	Date	Description	By
01	DEC 22/20	OWNER REVIEW & COORDINATION	J.M.
02	APR 28/21	OWNER REVIEW	J.M.
03	JUN 17/21	OWNER REVIEW	J.M.
04	JUN 29/21	REVIEW & COORDINATION	J.M.

Rev.	Date	Description	By
01	N/A	N/A	J.M.

ARCHITECT'S INSTRUCTIONS:
THE CONTRACTOR MUST CHECK AND VERIFY ALL DRAWING DIMENSIONS ON THE SITE BEFORE AND DURING CONSTRUCTION, AND REPORT TO THE ARCHITECT ANY DISCREPANCIES PRIOR TO COMMENCING WORK.
DRAWINGS ARE NOT TO BE SCALED FOR PURPOSES OF CONSTRUCTION.
ALL CONSTRUCTION DOCUMENTS ISSUED BY THE ARCHITECT ARE THE COPYRIGHT OF THE ARCHITECT AND MUST BE RETURNED UPON REQUEST.
REPRODUCTION OF THE CONSTRUCTION DOCUMENTS IN PART OR IN WHOLE IS FORBIDDEN WITHOUT THE ARCHITECT'S WRITTEN PERMISSION.

keith loffler mc Alpine architects
13 ST. MARY STREET, SUITE 402, TORONTO, ONTARIO, M5Y 1P9 T (416) 944 1982 F (416) 944 8248



Professional Certification

REVIEW & COORDINATION

Issued for	JUNE 29, 2021	Scale	1 : 250
Issue date	2028	Drawn by	J.M.
Project no.		Checked by	J.M.

Block 8
Condominium Residences
Brock St. E. & Herrema Blvd., Uxbridge, Ontario
OWNER: Evendale Developments, 905 904 2261

Architectural Site Plan
Site & Building Data

Drawing Title
A001
Sheet no.