

REV.	ALTERATION	DATE	BY

**LUMINAIR SPECIFICATIONS**  
 GE LED LIGHT: EASC-G-A3-F-5-40-A-D-BLK-L  
 QUANTITY: TEXTURED BLACK

**ARM SPECIFICATIONS**  
 CATALOGUE NO.: 348-1240  
 QUANTITY: TEXTURED BLACK

**POLE SPECIFICATIONS**  
 CATALOGUE NO.: E250-BPT-G-E11  
 QUANTITY: 5/1' 120

**SECTION:** SQUARE  
**COLOUR:** ECLIPSE  
**FINISH:** ETCHED  
**POLE TOP:** 4 3/4" FL/FL  
**POLE BUTT:** 7 7/8" FL/FL  
**LENGTH:** 25' 0"  
**APPROX. WEIGHT:** 8.36 lbs  
**MIN. RACEWAY:** 1 1/8" DIA.

**CASTING NUMBER:**  
 GE CODES: ACRYLIC  
 FULL LENGTH

**NAMEPLATE**  
 2 1/2" x 8" ZINC PLAT  
 PAINT: TEXTURED BLACK  
 C/W #6 GROUND WIRE x 18"  
 & ROBERTSON SCREWS

**TOP VIEW**  
 1/2" DIA. HOLES  
 1/2" DIA. HOLES  
 1/2" DIA. HOLES

**CUSTOMER ORDER NO.:** STRESSCRETE ORDER NO. 25619811-4

**STRESSCRETE ORDER NO.:** 25619811-4

**DATE:** 02/15/19

**REVISION:** 02/15/19

**DESIGNED BY:** CONCEPT DWG

**CHECKED BY:** SCJ

**DATE:** 02/15/19

**REVISION:** 02/15/19

**PROJECT/CLIENT:** TYMART CONCEPT

**PROJECT/LOCATION:** 25619811-4

**PROJECT/ADDRESS:** 25619811-4

**PROJECT/CITY:** 25619811-4

**PROJECT/STATE:** 25619811-4

**PROJECT/COUNTRY:** 25619811-4

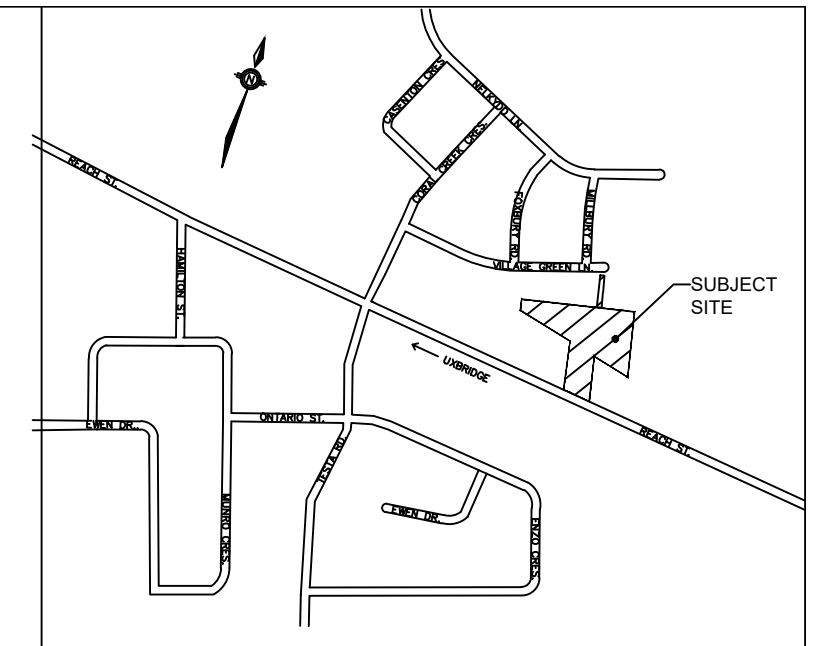

- LEGEND**
- PRIVATE STREETLIGHT ASSEMBLY
  - POLE: 25 SQUARE ETCHED BLACK CONCRETE POLE.
  - STRESS-CRETE CAT: E250-BPT-G-E11 S/F 120
  - FIXTURE: GE EALS 50W 3000K 120V LED WITH BACKSHIELDING.
  - CAT: GE EALS\_03\_0\_C2\_AN\_7\_30\_N\_A\_D1\_BLK PER PHOTOMETRIC FILE: EALS03\_C2AN730-AB-BLOCKIES
  - STREETLIGHT PEDESTAL SUPPLY CABLE: 3-#2 CU RWU-90 C/W JACKETED GND IN CONTINUOUS 50mm PVC TYPE 2 DUCT IN COMPLETE ACCORDANCE WITH E.S.A. STANDARDS & SPECIFICATIONS.
  - STREET LIGHT CABLE: 2-#6 CU RWU C/W 1-#6 JACKETED GREEN GND CABLE INSTALLED IN 50mm PVC TYPE 2 DIRECT BURIED DUCT.
  - 100mm PVC TYPE 2 DIRECT BURIED DUCT AT HYDRO ONE CROSSING LOCATION FOR STREETLIGHTING SYSTEM. DUCT QUANTITIES SHOWN ON THIS PLAN ARE EXCLUSIVELY FOR THE STREETLIGHTING SYSTEM.
  - METERED HOUSE SERVICE PANEL: 60A 2 POLE MAIN BREAKER, 4-40 BRANCH BREAKERS, PROVISION FOR UP TO 6 BRANCH BREAKERS TO BE LOCATED WITHIN WATER METER ROOM. INSTALLATION BY BUILDERS SITE ELECTRICIAN.
  - GROUND ROD TO BE INSTALLED PER E.S.A. AND TOWNSHIP OF UXBRIDGE STANDARDS AND SPECIFICATIONS.
  - PROPOSED TRANSFORMER LOCATION
  - DRIVEWAY

**Ordering Number Logic**  
 Evolve™ LED Area Light (EALS-G3)

**EALS 03 7**

CODE	DESCRIPTION	UNIT	QUANTITY	DESCRIPTION	UNIT	QUANTITY	DESCRIPTION	UNIT	QUANTITY
C5	Symmetri Medium DM	3000	1000	46	18-00001	18-00001	EALS03DM730	25	EALS03DM730
PS	Symmetri Medium DM	3000	1000	101	18-00001	18-00001	EALS03DM730	25	EALS03DM730
HS	Symmetri Medium DM	3000	1000	101	18-00001	18-00001	EALS03DM730	25	EALS03DM730
JS	Symmetri Medium DM	3000	1000	101	18-00001	18-00001	EALS03DM730	25	EALS03DM730
KS	Symmetri Medium DM	3000	1000	101	18-00001	18-00001	EALS03DM730	25	EALS03DM730
LS	Symmetri Medium DM	3000	1000	101	18-00001	18-00001	EALS03DM730	25	EALS03DM730
MS	Symmetri Medium DM	3000	1000	101	18-00001	18-00001	EALS03DM730	25	EALS03DM730
NS	Symmetri Medium DM	3000	1000	101	18-00001	18-00001	EALS03DM730	25	EALS03DM730
OS	Symmetri Medium DM	3000	1000	101	18-00001	18-00001	EALS03DM730	25	EALS03DM730
PS	Symmetri Medium DM	3000	1000	101	18-00001	18-00001	EALS03DM730	25	EALS03DM730
QS	Symmetri Medium DM	3000	1000	101	18-00001	18-00001	EALS03DM730	25	EALS03DM730
RS	Symmetri Medium DM	3000	1000	101	18-00001	18-00001	EALS03DM730	25	EALS03DM730
TS	Symmetri Medium DM	3000	1000	101	18-00001	18-00001	EALS03DM730	25	EALS03DM730
US	Symmetri Medium DM	3000	1000	101	18-00001	18-00001	EALS03DM730	25	EALS03DM730
VS	Symmetri Medium DM	3000	1000	101	18-00001	18-00001	EALS03DM730	25	EALS03DM730
WS	Symmetri Medium DM	3000	1000	101	18-00001	18-00001	EALS03DM730	25	EALS03DM730
XS	Symmetri Medium DM	3000	1000	101	18-00001	18-00001	EALS03DM730	25	EALS03DM730
YS	Symmetri Medium DM	3000	1000	101	18-00001	18-00001	EALS03DM730	25	EALS03DM730
ZS	Symmetri Medium DM	3000	1000	101	18-00001	18-00001	EALS03DM730	25	EALS03DM730

ACCEPTED TO BE IN GENERAL CONFORMANCE WITH THE TOWNSHIP OF UXBRIDGE STANDARDS. THIS ACCEPTANCE IS NOT TO BE CONSTRUED AS VERIFICATION OF ENGINEERING CONTENT.

AECOM Canada Ltd.

Date

REV	YYYY.MM.DD	DESCRIPTION	BY	CHECKED



**RTG SYSTEMS INC.**  
 ELECTRICAL CONSULTING ENGINEERS  
 3518 Mainway Dr., Suite 201 Office: (905) 335-4470  
 BURLINGTON ON L7M 1A8 Toronto: (905) 627-7887  
 E-MAIL: general@rtgsystems.com

**TOWNSHIP OF UXBRIDGE**

**REACH STREET TOWNHOMES DEVELOPMENT**

**STREET LIGHTING PLAN**

DWG BY	DATE	CHKD BY	DATE
T.J.G.	2021.08.09		

SCALE: 1:500 EXCEPT SYMBOLS

DRAWING NO. SL-1 SHEET 1 OF 1